

# PAL PANG

Architecture

4th Floor Imperial House 15 Kingsway London WC2B 6UN  
United Kingdom

View the full portfolio at <http://www.thecreativefinder.com/palpeng>

## Professional Experience and Curriculum Vitae

Upon graduation at the University of the Creative Arts in UK, Pal Pang received an honorary bachelors degree in interior design and returned to Hong Kong. He started out in a retail and commercial branch of interior design, such as shopping malls and residential development.

In 2002, Pal Pang founded Another Design International, and assumed the post as its Chief Designer. His tasteful designs and distinctive styles soon catapulted him to become a successful designer in Asia. Pang has worked with famous brands, both local and international, some of which include Hutchison Whampoa, Maxims, Jaguar, Kowloon Development, McDonald's, Wai Yuen Tong, LuLu Cheung and Evisu.

Pang's astute instincts for the needs of both the Asian and Western markets places him in good stead. He approaches his work with ferocity that is capable of delivering results with great international appeal.

In 2007, Wai Yuen Tong retail design won the Design for Asia Award. The following year, "The Morrison" clinched the UK International Property Awards, the Best Interior Design Award at the Asia-Pacific Awards as well as environmental awards at the Hong Kong Institute of Surveyors. "Horizon Heights", another of Pang's brainchild, won Best Interior Design at the Asia Pacific Property Awards 2010. In 2011, Pang was voted as one of the under-40 stars in Asia's design industry. Most recently, in 2012, Pang attained the prestigious Italian A' Design Award in Excellence in Design. His works and related interviews are often published in design magazines across Europe, Dubai, China and Hong Kong. Pang's first publication, titled "Design of Faith & Devotion", is now internationally sold.

Pal Pang is a designer who believes in the tenacity and significance of film, picture composition, lighting as well as other environment sound and sensory effects. He strives to reflect these elements in his design, creating masterpieces that are extraordinary in their tactile intuition, thus appealing to and satisfying his client's sophisticated tastes.

Aside from being an examiner at the Hong Kong Arts Development Council, Pang is currently a Fellow of the Chartered Society of Designers, Fellow of the Royal Society of Arts, Design and Art Direction Association and the Hong Kong Designers Association Full Member.

## Previous Clientele

Please kindly get in touch for more information.

## Awards and Accolades

Please kindly get in touch for more information.

## Awards and Accolades

Please kindly get in touch for more information.

15b Lloyd Road Singapore 239098 (co. reg. 201004398N)  
helpdesk 656.227.2902, fax 656.227.0213

# PAL PANG

Architecture

4th Floor Imperial House 15 Kingsway London WC2B 6UN  
United Kingdom

View the full portfolio at <http://www.thecreativefinder.com/palpang>



15b Lloyd Road Singapore 239098 (co. reg. 201004398N)  
helpdesk 656.227.2902, fax 656.227.0213

# PAL PANG

Architecture

4th Floor Imperial House 15 Kingsway London WC2B 6UN  
United Kingdom

View the full portfolio at <http://www.thecreativefinder.com/palpang>



15b Lloyd Road Singapore 239098 (co. reg. 201004398N)  
helpdesk 656.227.2902, fax 656.227.0213

# PAL PANG

Architecture

4th Floor Imperial House 15 Kingsway London WC2B 6UN  
United Kingdom

View the full portfolio at <http://www.thecreativefinder.com/palpang>



15b Lloyd Road Singapore 239098 (co. reg. 201004398N)  
helpdesk 656.227.2902, fax 656.227.0213



# PAL PANG

Architecture

4th Floor Imperial House 15 Kingsway London WC2B 6UN  
United Kingdom

View the full portfolio at <http://www.thecreativefinder.com/palpang>



15b Lloyd Road Singapore 239098 (co. reg. 201004398N)  
helpdesk 656.227.2902, fax 656.227.0213

# PAL PANG

Architecture

4th Floor Imperial House 15 Kingsway London WC2B 6UN  
United Kingdom

View the full portfolio at <http://www.thecreativefinder.com/palpang>



15b Lloyd Road Singapore 239098 (co. reg. 201004398N)  
helpdesk 656.227.2902, fax 656.227.0213

# PAL PANG

Architecture

4th Floor Imperial House 15 Kingsway London WC2B 6UN  
United Kingdom

View the full portfolio at <http://www.thecreativefinder.com/palpang>

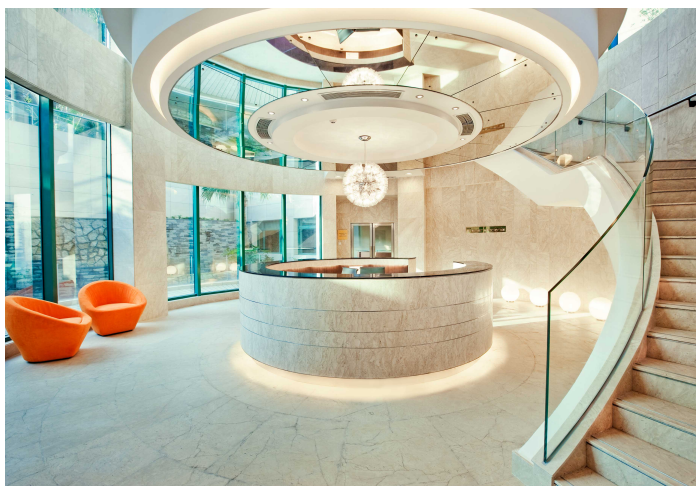

15b Lloyd Road Singapore 239098 (co. reg. 201004398N)  
helpdesk 656.227.2902, fax 656.227.0213



# PAL PANG

Architecture

4th Floor Imperial House 15 Kingsway London WC2B 6UN  
United Kingdom

View the full portfolio at <http://www.thecreativefinder.com/palpang>





# PAL PANG

Architecture

4th Floor Imperial House 15 Kingsway London WC2B 6UN  
United Kingdom

View the full portfolio at <http://www.thecreativefinder.com/palpang>



15b Lloyd Road Singapore 239098 (co. reg. 201004398N)  
helpdesk 656.227.2902, fax 656.227.0213

# PAL PANG

Architecture

4th Floor Imperial House 15 Kingsway London WC2B 6UN  
United Kingdom

View the full portfolio at <http://www.thecreativefinder.com/palpang>



15b Lloyd Road Singapore 239098 (co. reg. 201004398N)  
helpdesk 656.227.2902, fax 656.227.0213

# PAL PANG

Architecture

4th Floor Imperial House 15 Kingsway London WC2B 6UN  
United Kingdom

View the full portfolio at <http://www.thecreativefinder.com/palpang>



15b Lloyd Road Singapore 239098 (co. reg. 201004398N)  
helpdesk 656.227.2902, fax 656.227.0213

# PAL PANG

Architecture

4th Floor Imperial House 15 Kingsway London WC2B 6UN  
United Kingdom

View the full portfolio at <http://www.thecreativefinder.com/palpeng>



15b Lloyd Road Singapore 239098 (co. reg. 201004398N)  
helpdesk 656.227.2902, fax 656.227.0213



# PAL PANG

Architecture

4th Floor Imperial House 15 Kingsway London WC2B 6UN  
United Kingdom

View the full portfolio at <http://www.thecreativefinder.com/palpang>



15b Lloyd Road Singapore 239098 (co. reg. 201004398N)  
helpdesk 656.227.2902, fax 656.227.0213

# PAL PANG

Architecture

4th Floor Imperial House 15 Kingsway London WC2B 6UN  
United Kingdom

View the full portfolio at <http://www.thecreativefinder.com/palpang>



15b Lloyd Road Singapore 239098 (co. reg. 201004398N)  
helpdesk 656.227.2902, fax 656.227.0213

# PAL PANG

Architecture

4th Floor Imperial House 15 Kingsway London WC2B 6UN  
United Kingdom

View the full portfolio at <http://www.thecreativefinder.com/palpang>



15b Lloyd Road Singapore 239098 (co. reg. 201004398N)  
helpdesk 656.227.2902, fax 656.227.0213

# PAL PANG

Architecture

4th Floor Imperial House 15 Kingsway London WC2B 6UN  
United Kingdom

View the full portfolio at <http://www.thecreativefinder.com/palpang>



Please kindly get in touch for portfolio works.

15b Lloyd Road Singapore 239098 (co. reg. 201004398N)  
helpdesk 656.227.2902, fax 656.227.0213